

**Application:**

- Suitable for use as an electrical junction box, terminal box, and instrument housing
- Designed for indoor use and will protect components from falling dust, dirt, oil, and water

**Enclosure features:**

- Fabricated from 16 or 14 gauge steel with seam welds that are ground smooth
- Screw cover is secured with 304 stainless steel screws
- Includes a removable 14 gauge steel sub plate
- Door gasket is ¼" x ¾" Poron minimizing compression set
- Ground nuts are included on both the door and enclosure body
- Mounting feet are formed from enclosure body, reducing potential corrosion
- Enclosure is finished in ANSI-61 grey polyester powder coating over a phosphated surface
- Sub plate is finished in a white polyester powder coating over a phosphated surface

**Industry Standards:**

- NEMA 12
- CSA Type 12
- UL Type 12

THE SUB PLATE IS SUPPORTED INSIDE THE ENCLOSURE USING 4 WELD NUTS. NO SUB PLATE IS AVAILABLE FOR THE JS12-040403.

FRONT VIEW WITH NO DOOR

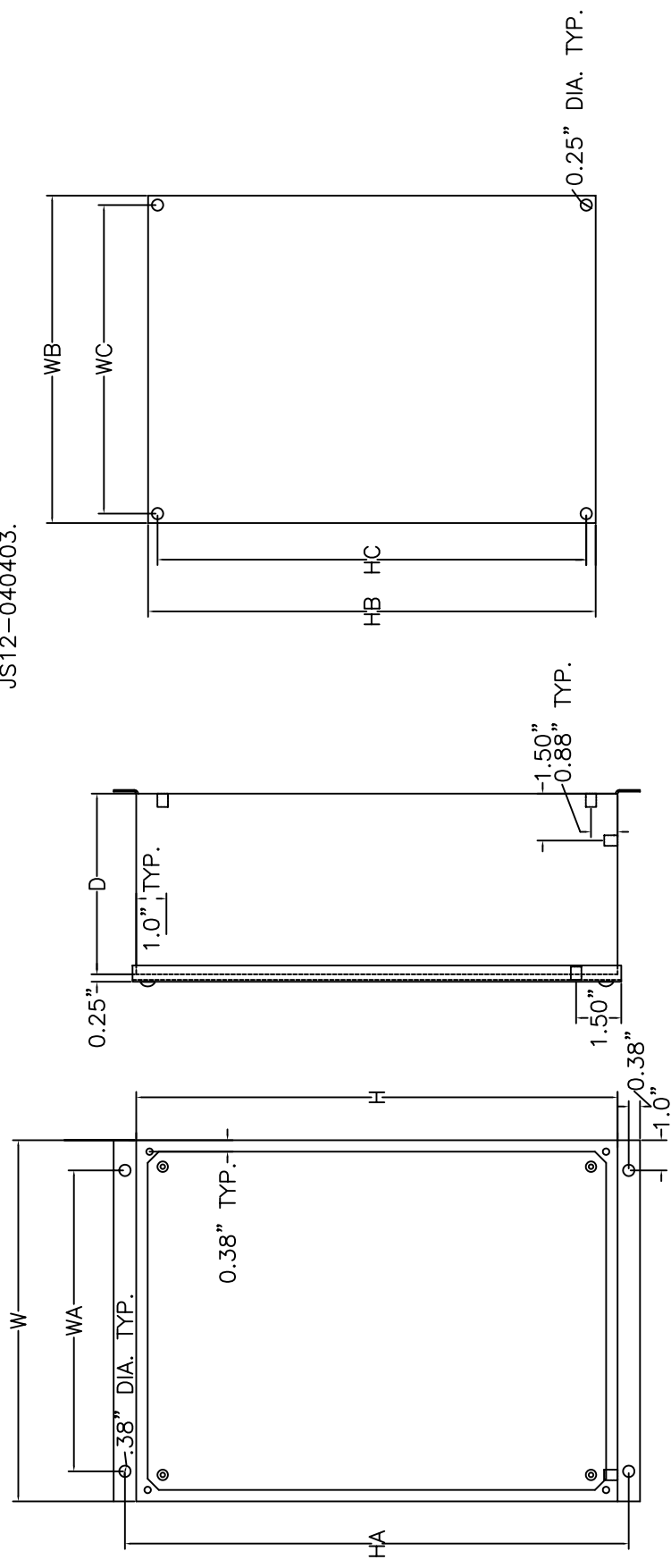

NOTE 1: ALL WELD NUTS ARE SUPPLIED WITH 10-32 SCREWS AND WASHERS

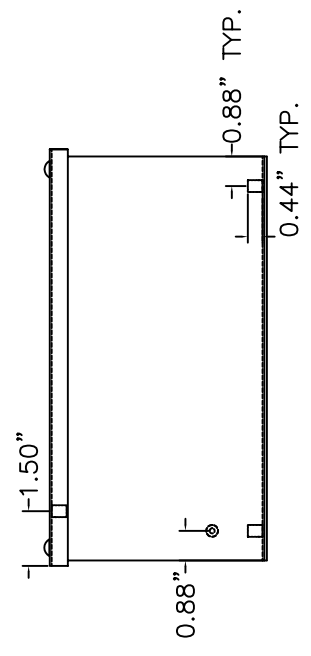

0.25" X 0.75" GASKET INSIDE PERIMETER OF DOOR  
SECTION Z-Z

REV	DESCRIPTION	DATE	APPL
	<b>EDI</b>		
NEMA 12 JIC STYLE ENCLOSURE WITH SCREW ON COVER			
MODEL NUMBER SERIES JS12			



## NEMA 12 JIC ENCLOSURE WITH SCREW COVER - SERIES JS12

Box Size			Model	Weight	Box Mounting		Plate size		Plate mounting	
H	W	D			HA	WA	HB	WB	HC	WC
4	4	3	JS12040403	2	4.75	2	0	0	0	0
4	4	4	JS12040404	2	4.75	2	0	0	0	0
4	6	3	JS12040603	3	4.75	4	2.88	4.88	2.25	4.25
6	4	3	JS12060403	3	6.75	2	4.88	2.88	4.25	2.25
6	6	3	JS12060603	4	6.75	4	4.88	4.88	4.25	4.25
6	6	4	JS12060604	5	6.75	4	4.88	4.88	4.25	4.25
6	6	5	JS12060605	6	6.75	4	4.88	4.88	4.25	4.25
6	8	4	JS12060804	6	6.75	6	4.88	6.75	4.25	6.25
6	8	5	JS12060805	6	6.75	6	4.88	6.75	4.25	6.25
6	10	4	JS12061004	8	6.75	8	4.88	8.75	4.25	8.25
6	10	5	JS12061005	9	6.75	8	4.88	8.75	4.25	8.25
6	12	4	JS12061204	13	6.75	10	4.88	10.75	4.25	10.25
6	12	5	JS12061205	14	6.75	10	4.88	10.75	4.25	10.25
8	4	3	JS12080403	6	8.75	3	6.75	3.88	6.25	3.25
8	6	4	JS12080604	6	8.75	4	6.75	4.88	6.25	4.25
8	6	5	JS12080605	6	8.75	4	6.75	4.88	6.25	4.25
8	8	4	JS12080804	8	8.75	6	6.75	6.88	6.25	6.25
8	8	5	JS12080805	9	8.75	6	6.75	6.88	6.25	6.25
8	8	6	JS12080806	10	8.75	6	6.75	6.88	6.25	6.25
8	10	4	JS12081004	10	8.75	8	6.88	8.75	6.25	8.25
8	10	5	JS12081005	11	8.75	8	6.88	8.75	6.25	8.25
8	10	6	JS12081006	12	8.75	8	6.88	8.75	6.25	8.25
8	12	4	JS12081204	12	8.75	10	6.88	10.75	6.25	10.25
8	12	5	JS12081205	13	8.75	10	6.88	10.75	6.25	10.25
8	12	6	JS12081206	14	8.75	10	6.88	10.75	6.25	10.25
8	14	6	JS12081406	17	8.75	12	6.88	12.75	6.25	12.25
10	6	4	JS12100604	8	10.75	4	8.75	4.88	8.25	4.25
10	6	5	JS12100605	9	10.75	4	8.75	4.88	8.25	4.25
10	8	4	JS12100804	10	10.75	6	8.75	6.88	8.25	6.25
10	8	5	JS12100805	11	10.75	6	8.75	6.88	8.25	6.25
10	8	6	JS12100806	12	10.75	6	8.75	6.88	8.25	6.25
10	10	4	JS12101004	11	10.75	8	8.75	8.88	8.25	8.25
10	10	5	JS12101005	12	10.75	8	8.75	8.88	8.25	8.25
10	10	6	JS12101006	13	10.75	8	8.75	8.88	8.25	8.25

**1-877-EDIRECT (334-7328)**  
**ENCLOSURES DIRECT INC.**

**FAX: (613) 723-4479**  
**sales@buyedi.com**



## NEMA 12 JIC ENCLOSURE WITH SCREW COVER - SERIES JS12

Box Size			Model	Weight	Box Mounting		Plate size		Plate mounting	
H	W	D			HA	WA	HB	WB	HC	WC
10	10	8	JS12101008	14	10.75	8	8.75	8.88	8.25	8.25
10	12	4	JS12101204	13	10.75	10	8.88	10.75	8.25	10.25
10	12	5	JS12101205	14	10.75	10	8.88	10.75	8.25	10.25
10	12	6	JS12101206	15	10.75	10	8.88	10.75	8.25	10.25
10	12	8	JS12101208	17	10.75	10	8.88	10.75	8.25	10.25
10	14	6	JS12101406	17	10.75	12	8.88	12.75	8.25	12.25
10	14	8	JS12101408	19	10.75	12	8.88	12.75	8.25	12.25
10	16	6	JS12101606	20	10.75	14	8.88	14.75	8.25	14.25
10	16	8	JS12101608	22	10.75	14	8.88	14.75	8.25	14.25
12	6	4	JS12120604	13	12.75	4	10.75	4.88	10.25	4.25
12	6	5	JS12120605	14	12.75	4	10.75	4.88	10.25	4.25
12	8	4	JS12120804	12	12.75	6	10.75	6.88	10.25	6.25
12	8	5	JS12120805	13	12.75	6	10.75	6.88	10.25	6.25
12	8	6	JS12120806	14	12.75	6	10.75	6.88	10.25	6.25
12	10	4	JS12121004	13	12.75	8	10.75	8.88	10.25	8.25
12	10	5	JS12121005	14	12.75	8	10.75	8.88	10.25	8.25
12	10	6	JS12121006	15	12.75	8	10.75	8.88	10.25	8.25
12	10	8	JS12121008	17	12.75	8	10.75	8.88	10.25	8.25
12	12	4	JS12121204	16	12.75	10	10.75	10.88	10.25	10.25
12	12	5	JS12121205	17	12.75	10	10.75	10.88	10.25	10.25
12	12	6	JS12121206	18	12.75	10	10.75	10.88	10.25	10.25
12	12	8	JS12121208	20	12.75	10	10.75	10.88	10.25	10.25
12	12	10	JS12121210	22	12.75	10	10.75	10.88	10.25	10.25
12	14	6	JS12121406	20	12.75	12	10.88	12.75	10.25	12.25
12	14	8	JS12121408	22	12.75	12	10.88	12.75	10.25	12.25
12	14	10	JS12121410	24	12.75	12	10.88	12.75	10.25	12.25
12	16	6	JS12121606	22	12.75	14	10.88	14.75	10.25	14.25
12	16	8	JS12121608	25	12.75	14	10.88	14.75	10.25	14.25
12	16	10	JS12121610	27	12.75	14	10.88	14.75	10.25	14.25
14	8	6	JS12140806	17	14.75	6	12.75	6.88	12.25	6.25
14	10	6	JS12141006	17	14.75	8	12.75	8.88	12.25	8.25
14	10	8	JS12141008	19	14.75	8	12.75	8.88	12.25	8.25
14	12	6	JS12141206	20	14.75	10	12.75	10.88	12.25	10.25
14	12	8	JS12141208	22	14.75	10	12.75	10.88	12.25	10.25

**1-877-EDIRECT (334-7328)**  
**ENCLOSURES DIRECT INC.**

**FAX: (613) 723-4479**  
**sales@buyedi.com**



## NEMA 12 JIC ENCLOSURE WITH SCREW COVER - SERIES JS12

Box Size			Model	Weight	Box Mounting		Plate size		Plate mounting	
H	W	D			HA	WA	HB	WB	HC	WC
14	12	10	JS12141210	24	14.75	10	12.75	10.88	12.25	10.25
14	14	6	JS12141406	22	14.75	12	12.75	12.88	12.25	12.25
14	14	8	JS12141408	25	14.75	12	12.75	12.88	12.25	12.25
14	14	10	JS12141410	27	14.75	12	12.75	12.88	12.25	12.25
14	16	6	JS12141606	23	14.75	14	12.88	14.75	12.25	14.25
14	16	8	JS12141608	26	14.75	14	12.88	14.75	12.25	14.25
14	16	10	JS12141610	29	14.75	14	12.88	14.75	12.25	14.25
16	10	6	JS12161006	20	16.75	8	14.75	8.88	14.25	8.25
16	10	8	JS12161008	22	16.75	8	14.75	8.88	14.25	8.25
16	12	6	JS12161206	22	16.75	10	14.75	10.88	14.25	10.25
16	12	8	JS12161208	25	16.75	10	14.75	10.88	14.25	10.25
16	12	10	JS12161210	27	16.75	10	14.75	10.88	14.25	10.25
16	14	6	JS12161406	23	16.75	12	14.75	12.88	14.25	12.25
16	14	8	JS12161408	26	16.75	12	14.75	12.88	14.25	12.25
16	14	10	JS12161410	29	16.75	12	14.75	12.88	14.25	12.25

**1-877-EDIRECT (334-7328)**  
**ENCLOSURES DIRECT INC.**

**FAX: (613) 723-4479**  
**sales@buyedi.com**